

CHT-2061

RECESSED SHORT WOOD GRAIN PANEL STEEL INSULATED DOOR

SERIES FEATURES

- 2"(50.8mm) - Thick CFC-Free Polyurethane
- 17.66 Calculated R-Value
- .057 Calculated U-Value
- 26-Gauge Galvanized Steel
- Air Infiltration Seal
- Meets ASHRAE 90.1 Air Infiltration Requirements
- Full Thermal Break
- Available with Wind Load
- 21 Color Options
- 10-Year Rust & Delamination Warranty
- 1-Year Hardware
- 1-Year Spring

Cross Section

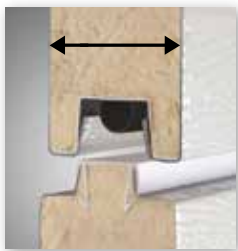

**2" (50.8mm)
Thick Sections**

AVAILABLE COLORS



Colors are not exact due to the differences in monitor and printer calibrations. For accurate color samples, contact Haas Door for a metal color selector. Trinar® colors carry a 35 year paint warranty.

MODEL FEATURES

- Extruded End Cap
- Recessed Short Panel wood grain embossment on outside, V-Groove pattern wood grain embossment on inside
- Tongue and groove section joint

Exterior View



Interior View



2000 SERIES LINKS

Click links for info.

[HOMEPAGE](#)

[BIM](#)

[BROCHURE](#)

[SPECS](#)

[GALLERY](#)

[SPECWIZARD](#)

[CAD](#)

[CATALOG](#)

Rev. 2.1 – October 2017