

**CHT-750 V-GROOVE STUCCO ALUMINUM INSULATED DOOR**

**SERIES FEATURES**

- 1 3/4"(44.5mm) - Thick CFC-Free Polyurethane
- 16.18 Calculated R-Value
- .062 Calculated U-Value
- 24-Gauge Stucco Aluminum
- Full Thermal Break
- Available with Wind Load
- 2 Color Options
- Industry Leading Warranty
- 10-Year Corrosion & Delamination
- 6-Year Hardware
- 3-Year Spring

**Cross Section**

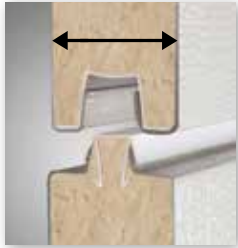

**1 3/4" (44.5mm)  
Thick Sections**

**AVAILABLE COLORS**

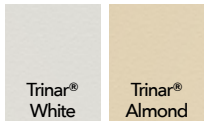

Colors are not exact due to the differences in monitor and printer calibrations. For accurate color samples, contact Haas Door for a metal color selector. Trinar® colors carry a 35 year paint warranty.

**MODEL FEATURES**

- 16ga. Galvanized Steel End Stiles
- V-groove stucco embossment outside, V-groove stucco embossment inside
- Tongue and groove section joint

**Exterior View**



**Interior View**



**700 SERIES LINKS**

*Click links for info.*

[HOMEPAGE](#)

[BIM](#)

[BROCHURE](#)

[SPECS](#)

[GALLERY](#)

[SPECWIZARD](#)

[CAD](#)

[CATALOG](#)

Rev. 2.1 – October 2017